

SAMPLE PLOT PLAN

(Three copies required)

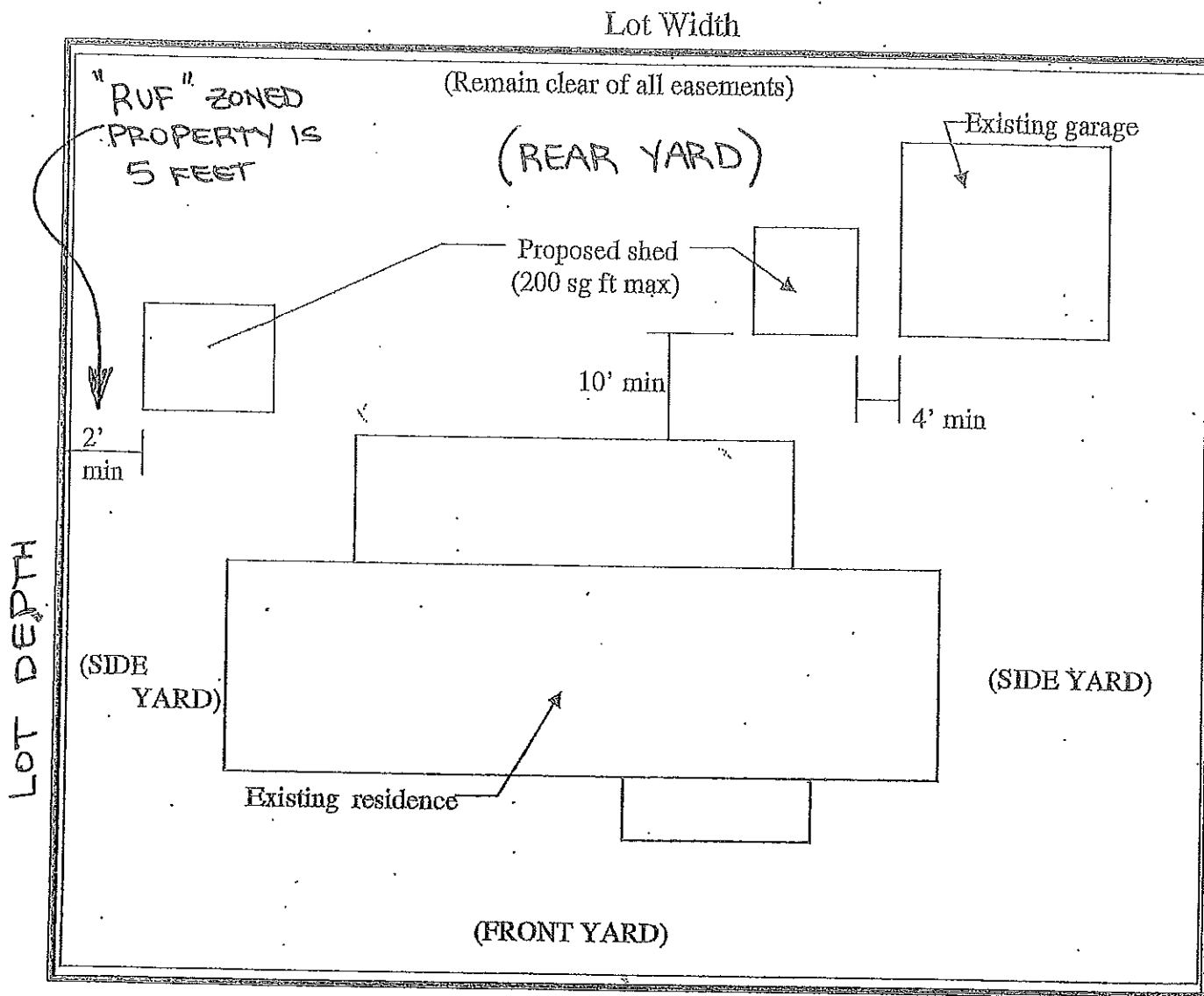

Street Frontage

How To Figure How Much Concrete Is Needed

For a Slab:

When pouring a slab, you need to know how many square feet you have. To figure square footage, take your length and multiply it by the width, that will be the number of square feet in that area.

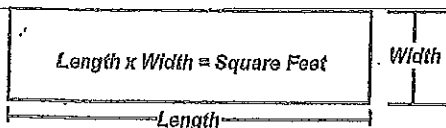

Once you know the number of square feet, then look below at the depth and divide by the number of square feet covered by a yard.

Depth covered by 1 yard	Number of square feet	Depth	Number of square feet covered by 1 yard
4"	80 sq. ft.	10"	32 sq. ft.
6"	54 sq. ft.	12"	27 sq. ft.
8"	40 sq. ft.		

For a Footing (or ratwall):

When pouring a footing, you need to know how many lineal feet you have. Measure all sides that are going to have a footing. Then look below at the depth and width chart to tell you what 1 yard will cover. Then divide by the total feet you have.

Width	Number of lineal feet 1 yard will cover at 24" deep	Number of lineal feet 1 yard will cover at 42" deep
4"	40 Lineal ft.	23 Lineal ft.
6"	27 Lineal ft.	15 Lineal ft.
8"	20 Lineal ft.	11 Lineal ft.
10"	16 Lineal ft.	9 Lineal ft.
12"	13 Lineal ft.	7 Lineal ft.

STORAGE SHEDS - ACCESSORY BUILDINGS

1. A zoning permit is required for any storage shed or accessory building from 40 square feet to and including 200 square feet. (A structure in area of 5' x 8' or equivalent to and including 10' x 20' or equivalent.)
2. 16 feet is maximum height of the building as measured from the ground to the ridge of the roof.
3. Storage sheds and accessory buildings are to be located in the rear yard only.
4. Ten (10) feet is maximum height of building sidewall as measured from the ground to the eave of the roof.
5. Buildings are to be located off any easements on the property.
6. Buildings may be located as close as two (2) feet to the side lot line and rear lot line provided there is no easement. Many rear easements are six (6) feet or larger.
7. For corner lots, the building is to be located no closer to the side street lot line than that of the main dwelling.
8. Sheds and accessory buildings are to be located a minimum of four (4) feet from detached garages and a minimum of ten (10) feet from dwellings and attached garages.
9. A minimum of 4" wide and 24" deep poured concrete ratwall is required for all sheds and accessory buildings from 40 square feet to 200 square feet.
10. If a concrete slab is not poured in conjunction with the required ratwall, then the top of the ratwall is to be 4" above the ground. A building with its own treated floor is to be attached to the top of the ratwall.
11. Shed and accessory buildings may be of wood, metal or plastic construction or other approved material.
12. A door to access the shed shall not exceed six (6) feet in width.
13. 15# felt is required under shingles on roofs of buildings of wood construction. Shingles are to be installed per the manufacturer's specifications.
14. Site built units are to conform to basic industry and construction standards.

15. Submit a complete zoning permit application with three (3) copies of a plot plan (see sample on other side) showing size and location of the proposed building as well as size and location of all other existing structures (dwelling and any garage or other accessory buildings).

16. Storage sheds and accessory buildings are not be used for the storage of automobiles or trucks as that is a garage use.